

GENERAL INFORMATION

ATTENTION CRESTLINE® DAMPENER OWNER!

Accel Graphic Systems provides parts and service through its authorized distributors and dealers. Therefore, all requests for parts and service should be directed to your local dealer.

The philosophy of Accel Graphic Systems is to continually improve all of its products. Written notices of changes and improvements are sent to Accel Graphic System's Dealers.

If the operating characteristics or the appearance of your product differs from those described in this manual, please contact your local Accel Graphic System's Dealer for updated information and assistance.

Always update your dampener when improvements are made available, especially those related to safety.

YOUR AUTHORIZED CRESTLINE® DEALER IS:

**THE SERIAL NUMBER OF YOUR
CRESTLINE® DAMPENER(S) IS:**

SAFETY INFORMATION

FOR YOUR SAFETY, DO NOT DISENGAGE OR REMOVE ANY GUARDS FROM THE CRESTLINE® DAMPENER. THE DAMPENER CONTAINS SOME INWARD ROTATING ROLLER NIPS THAT CAN CAUSE INJURY IF LEFT UNGUARDED.

GENERAL INFORMATION

- REQUIRED TOOLS**
1. 10 mm Open End Wrench
 2. Spring Hook Tool
 3. 3/32" Allen Wrench
 4. 1/8" Allen Wrench
 5. 1/2" Open End Wrench
 6. 7/16" Open End Wrench
 7. 4 mm Allen Wrench
 8. 2.5 mm Allen Wrench
 9. 3 mm Allen Wrench
 10. Snips or Saw

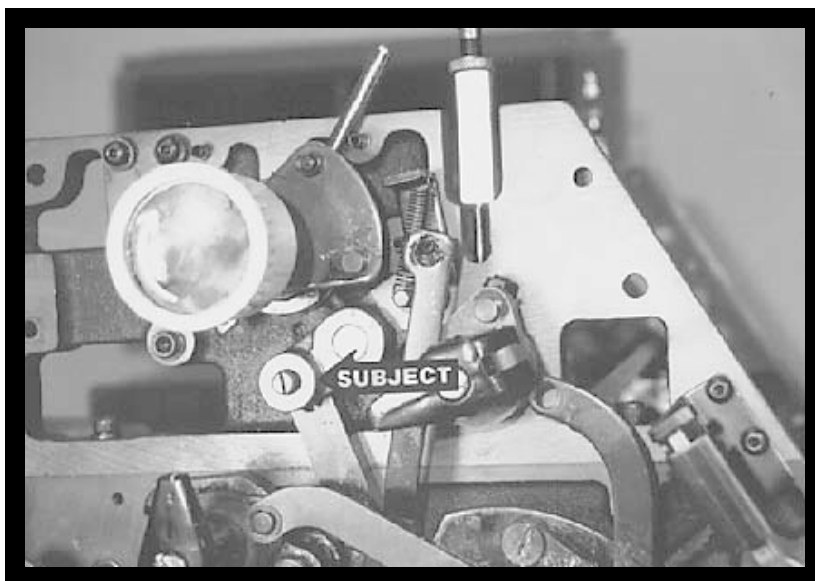
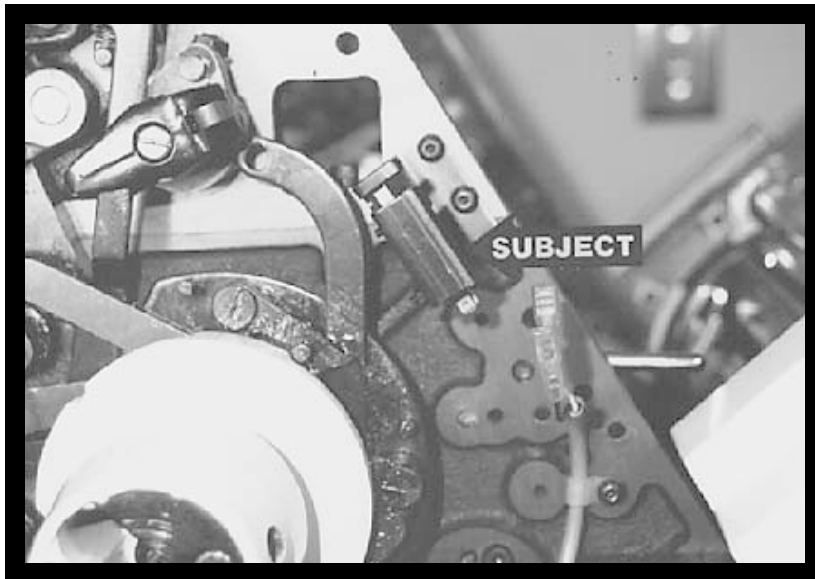
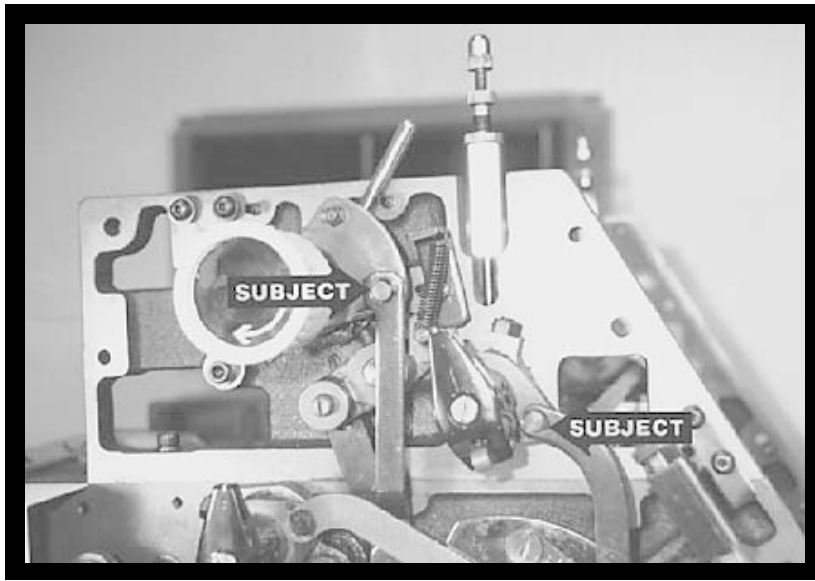

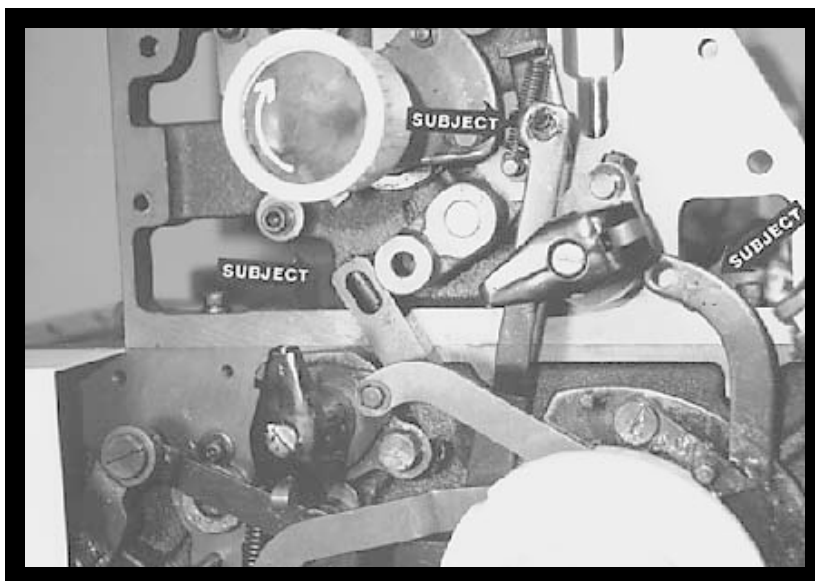
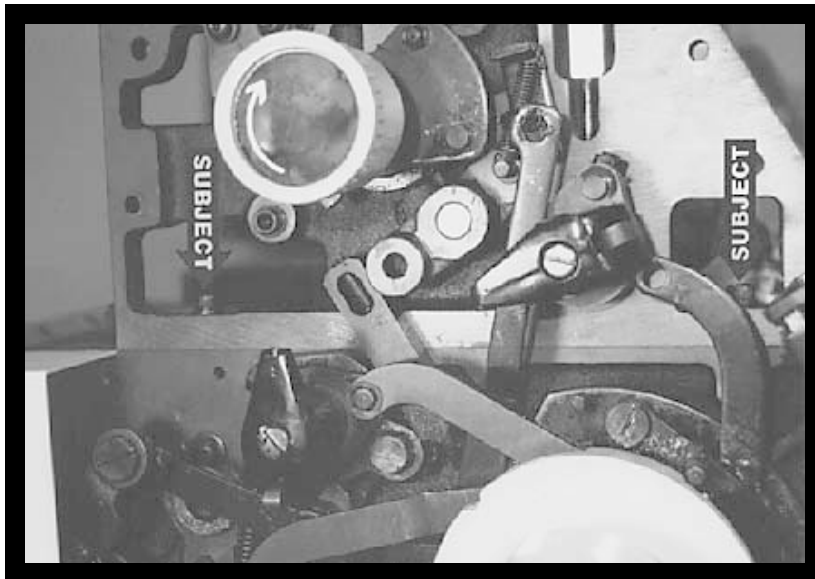
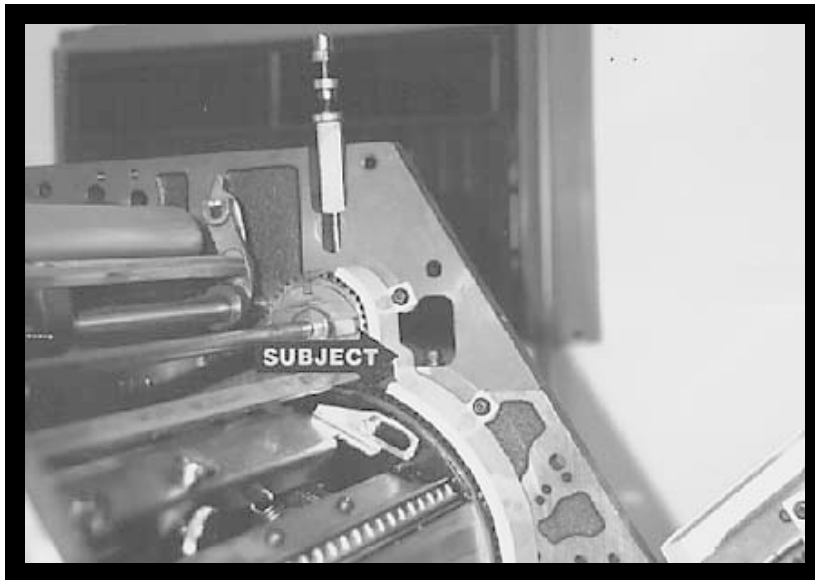

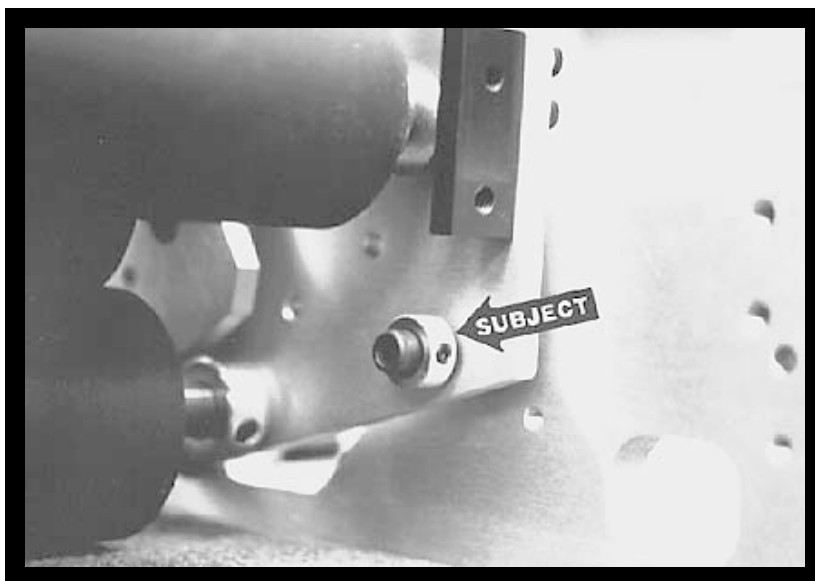
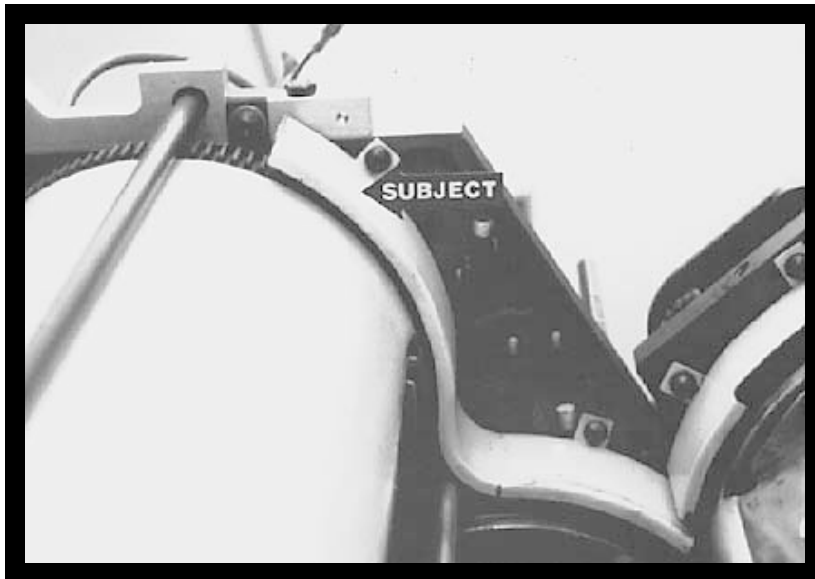
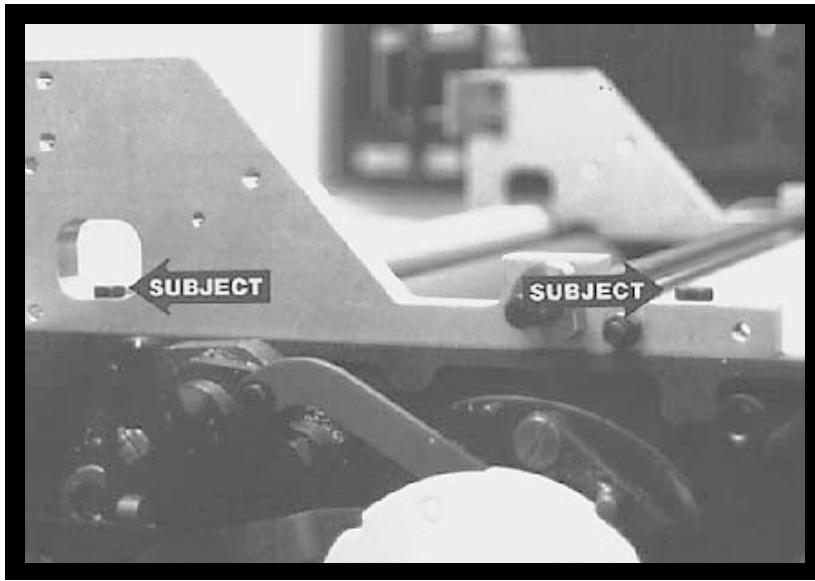

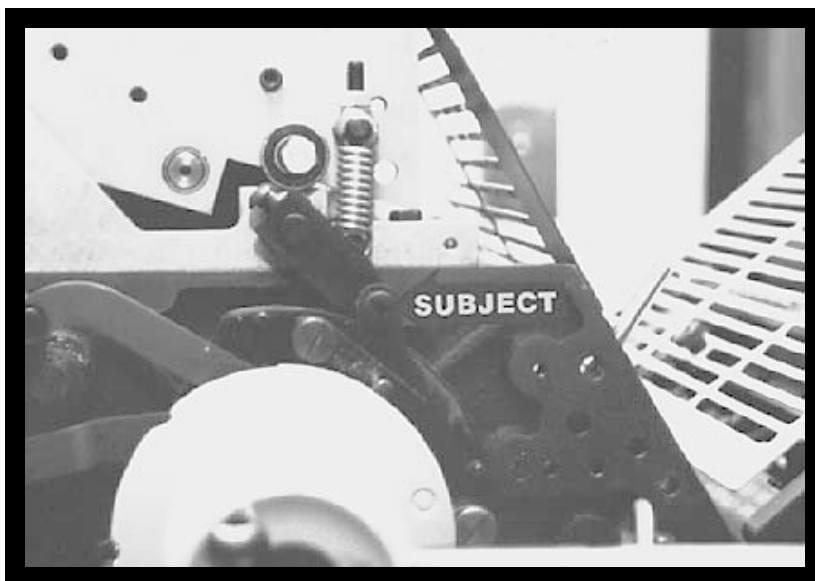
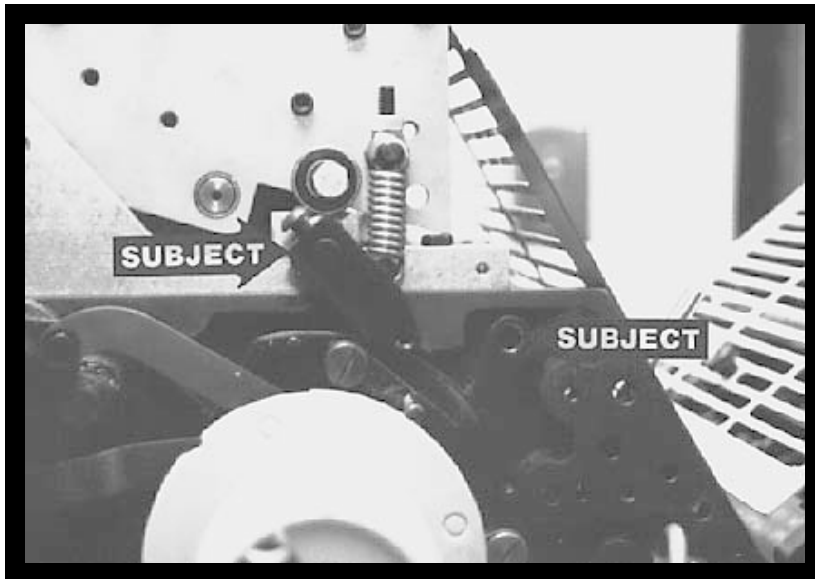
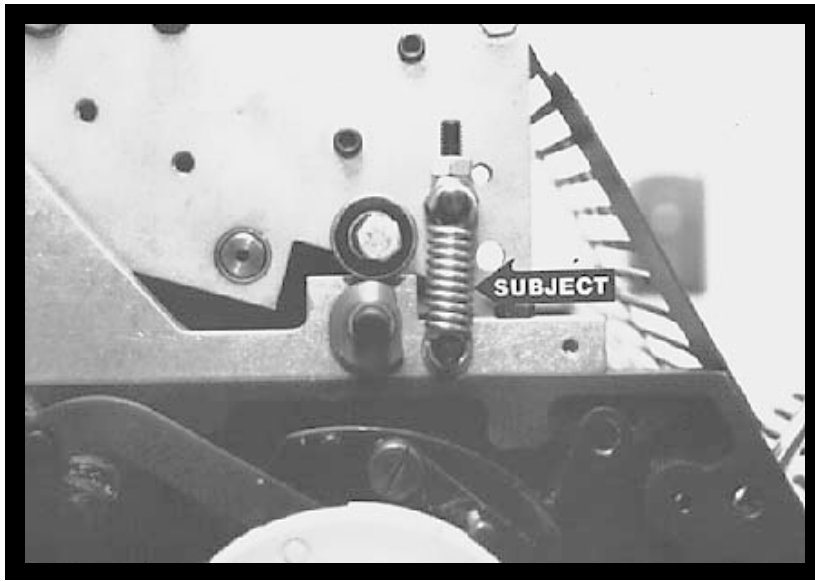

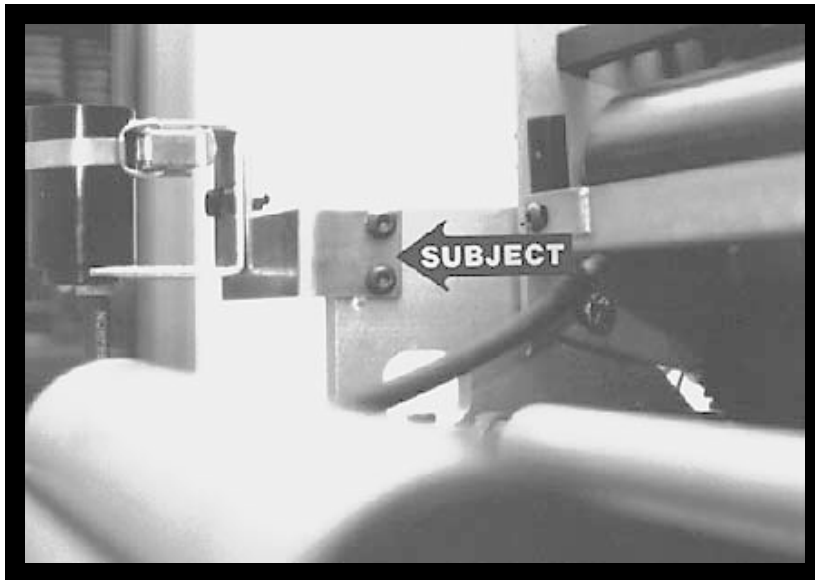

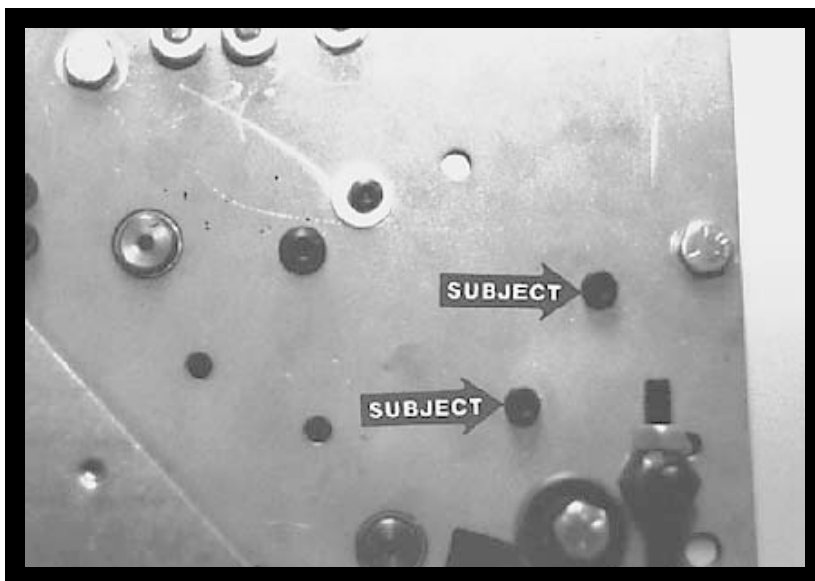
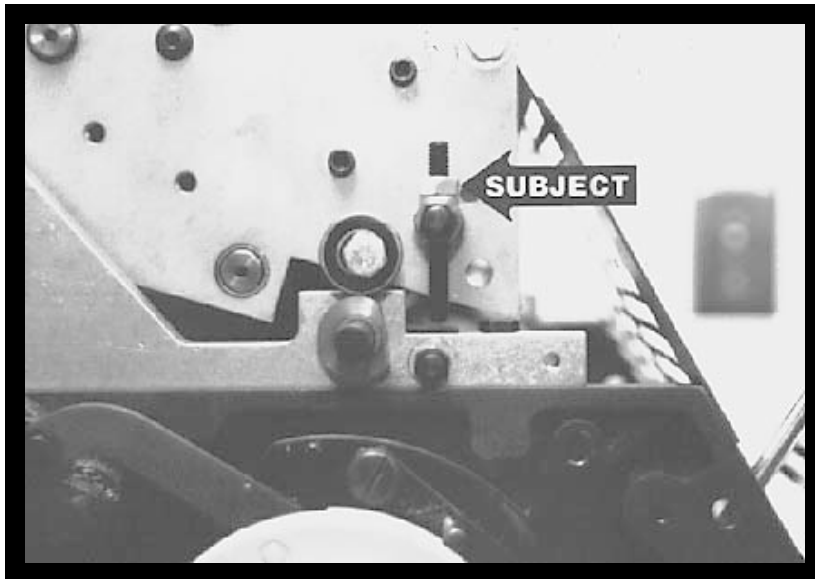
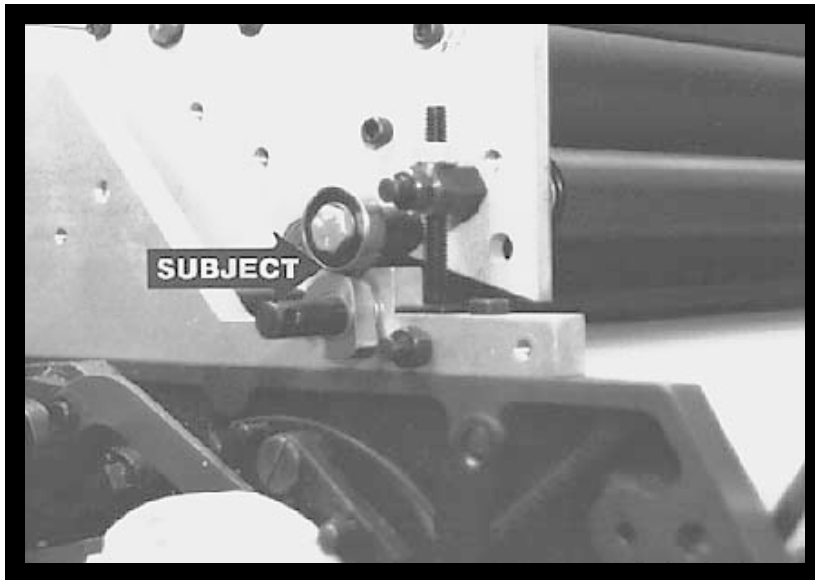

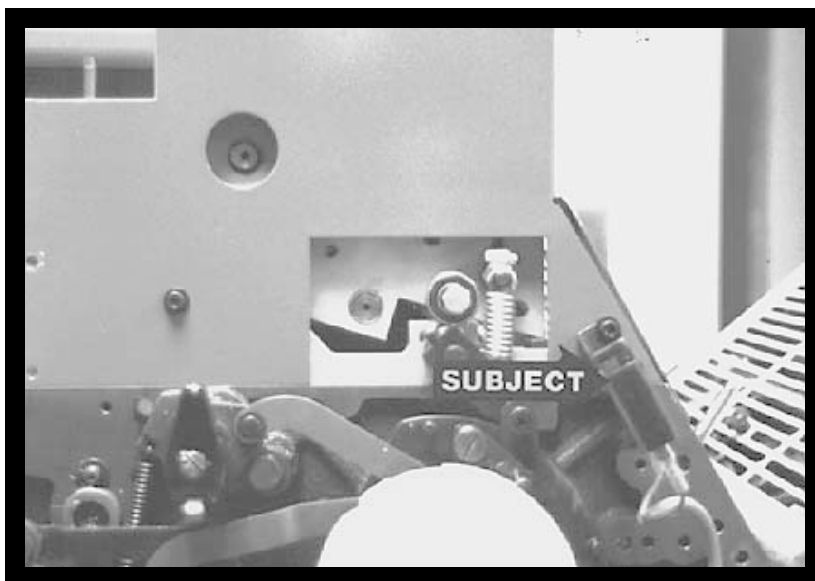
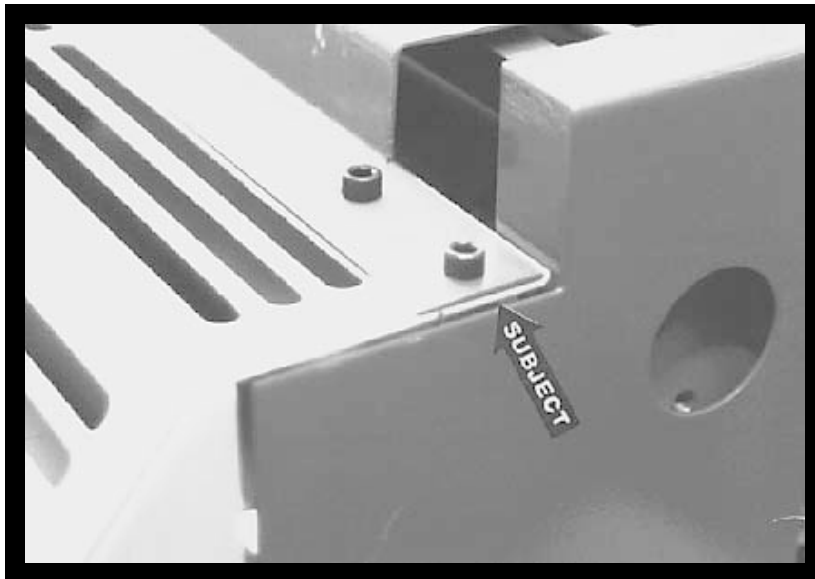
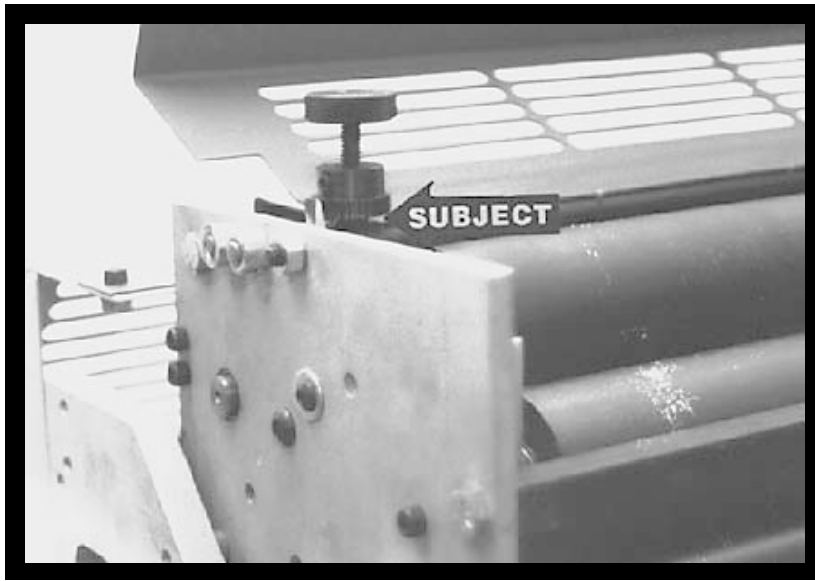

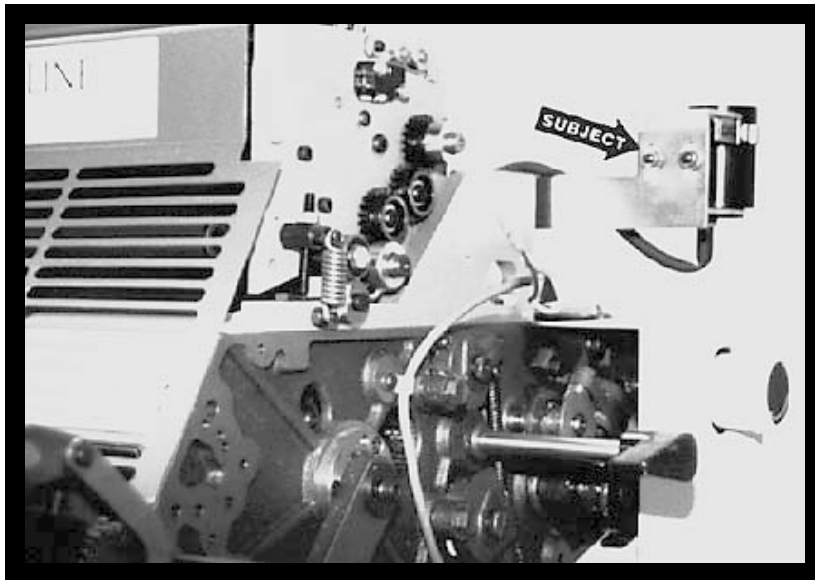

BASIC OPERATION

START OF DAY

- A. Make sure the oscillator, lower intermediate and metering rollers are in place. Roll pin in intermediate goes to the NOPS.
- B. Spin knurled knobs until the shoulder on the ratchet stops against the stud bar.
- C. Mount plate to cylinder. Wipe down all plates before running. Pre-ink the Crestline® dampener before running the plates with an extremely light coverage of ink. Dab the ink on the oscillator only.
- D. Place water bottle in bracket.

NOTE: Accel recommends using the proper fountain solution for the plate material being run on the press. A good acid/gum etch should be used with metal plates.

RUNNING DURING THE DAY

- A. In general, the Crestline® Dampener should not have to be adjusted from job to job. The form roller setting should never be changed unless it has deviated from the factory specification of 5/32" to the plate.
- B. Adjustments to the amount of water fed to the plate are made by the knurled knobs that apply pressure to the metering roller. The dampener has been set up for minimum water. To increase the water to the plate, turn the knurled knobs counter clockwise 1 or 2 clicks at a time. This opens the gap between the metering and pan rollers and allows more water to the plate.
- C. In general, more water will only be required when going from a metal plate to an electrostatic or Silvermaster type plate.

CLEANING & MAINTENANCE

DEGLAZING THE DAMPENER

Periodic deglazing of water-soluble contaminants will be necessary with the CrestLine®. Typically, once every 2-3 weeks will be sufficient, unless you are running electrostatic plates on a daily basis whereas deglazing should be performed weekly. A 50/50 solution of household ammonia and hot water can be used for deglazing purposes. If you prefer a commercially available deglazer, avoid those containing pumice or gritty substances. Always follow deglazing with straight water and then roller wash. Accel offers a product called **COMPOUND X** that we recommend for deglazing our system. Contact your dealer or Accel for more information.

OILING AND GREASING THE DAMPENER

- A. Place a small amount of grease on the gears once a month.
- B. Inject grease into the oscillator grease fitting one a month.
- C. Place a drop of oil near oil bushings once a week.

HAMADA 611/611E/612/612E-OPS

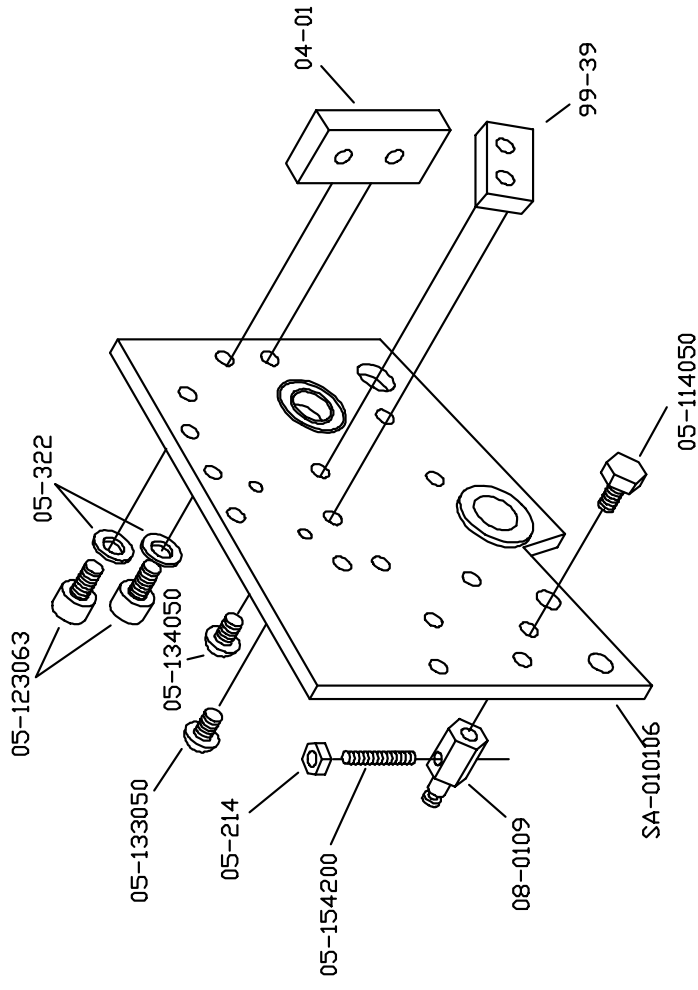

HAMADA 611/611E/612/612E-DPS

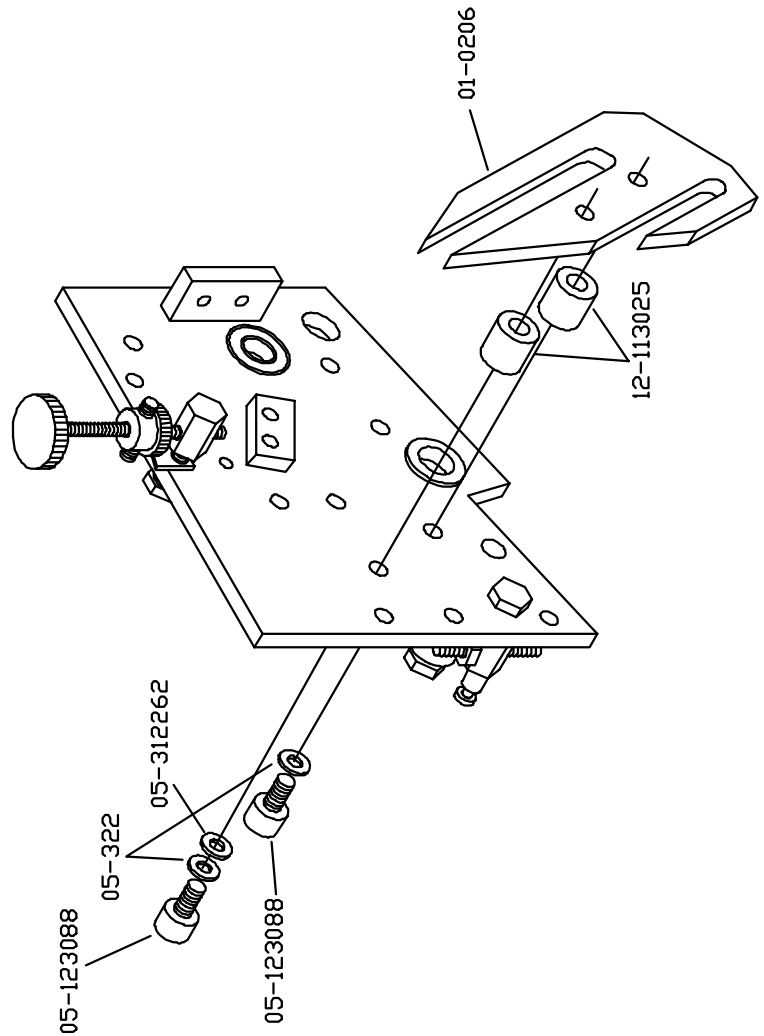

HM611C03 8-19-97

HAMADA 611/611E/612/612E-NDPS

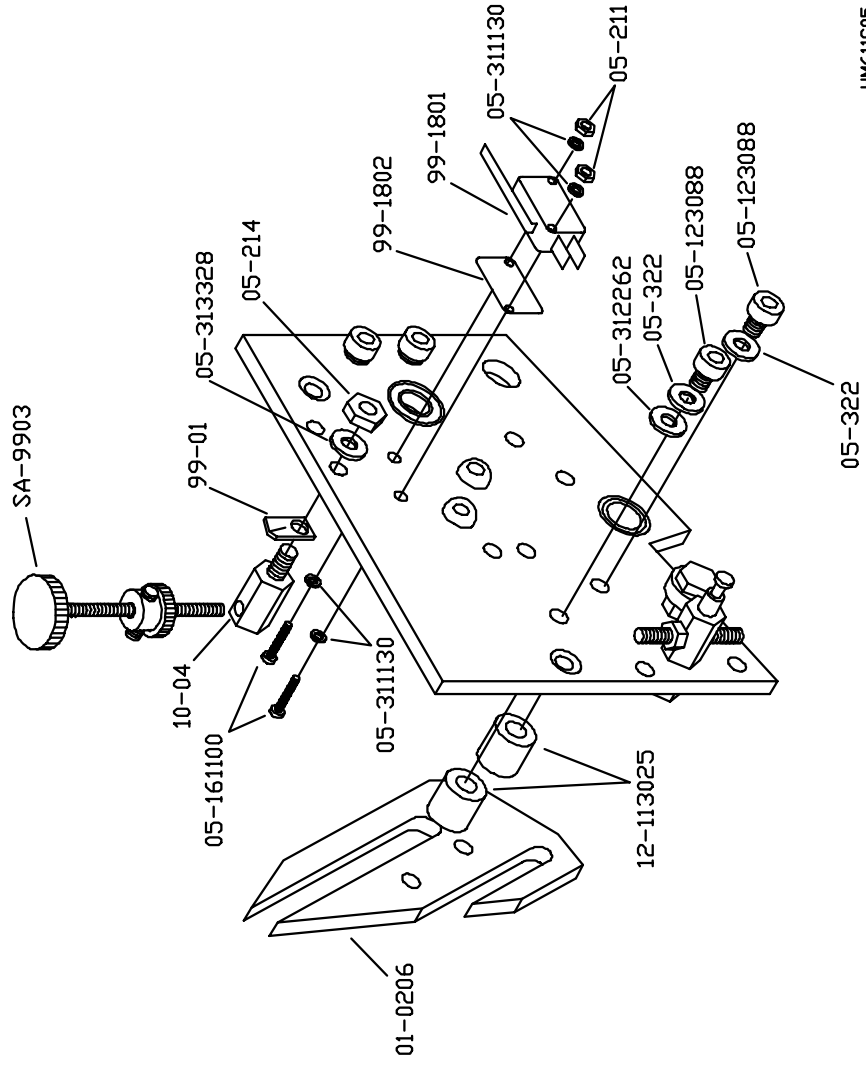

HAMADA 611/612 ONLY

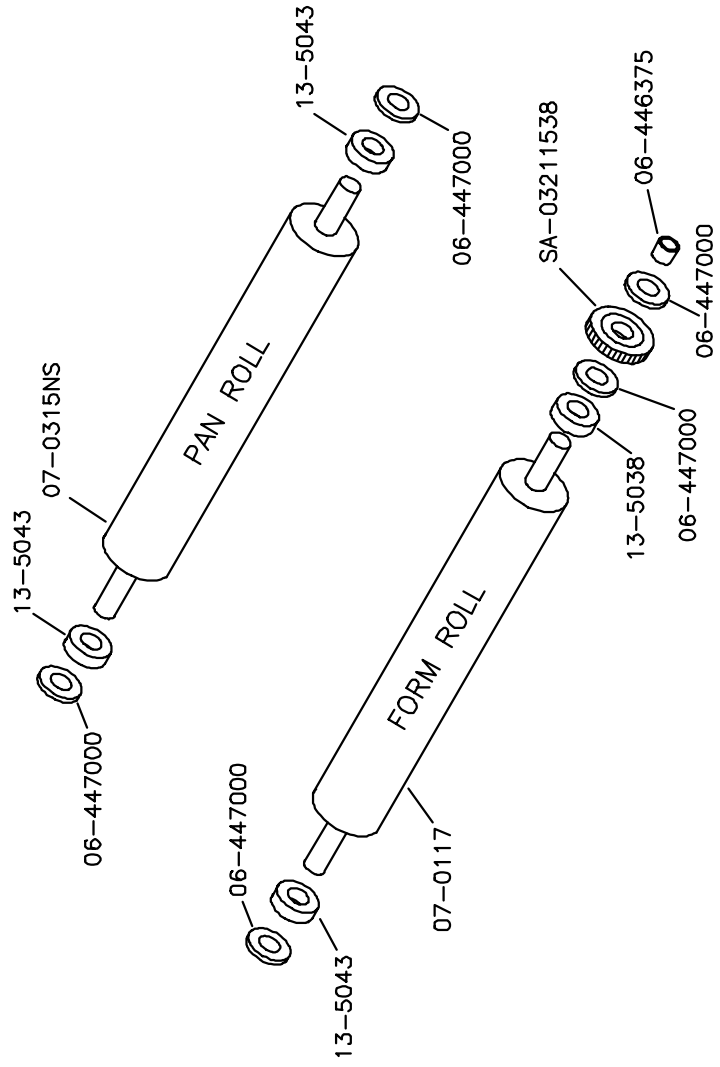

HAMADA 611/611E/612/612E

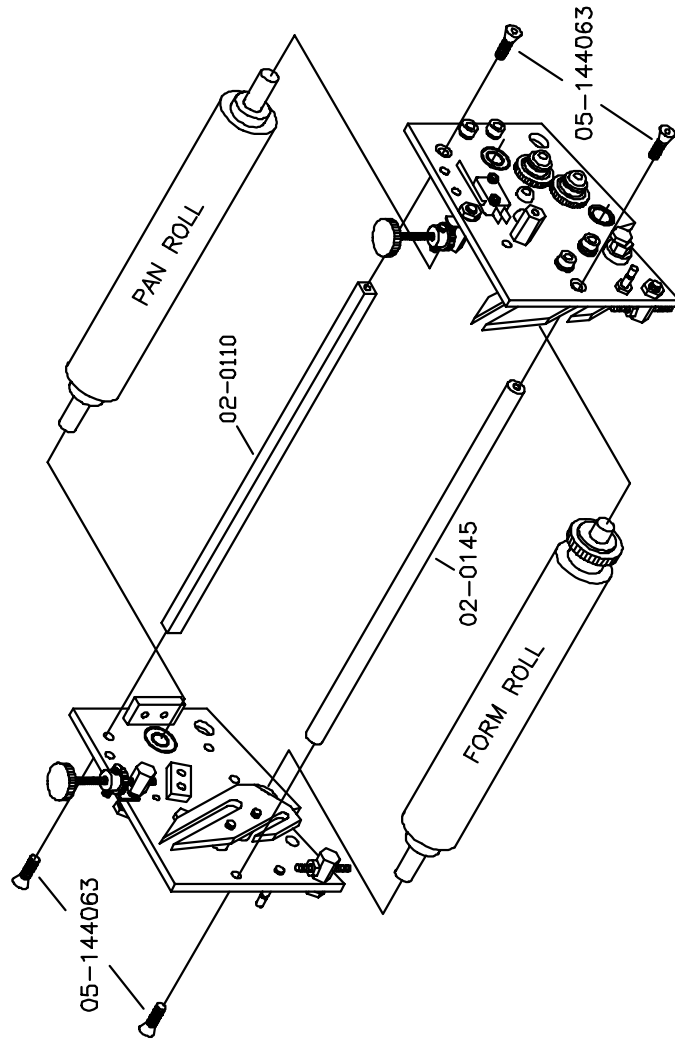

HAMADA 611/612 ONLY

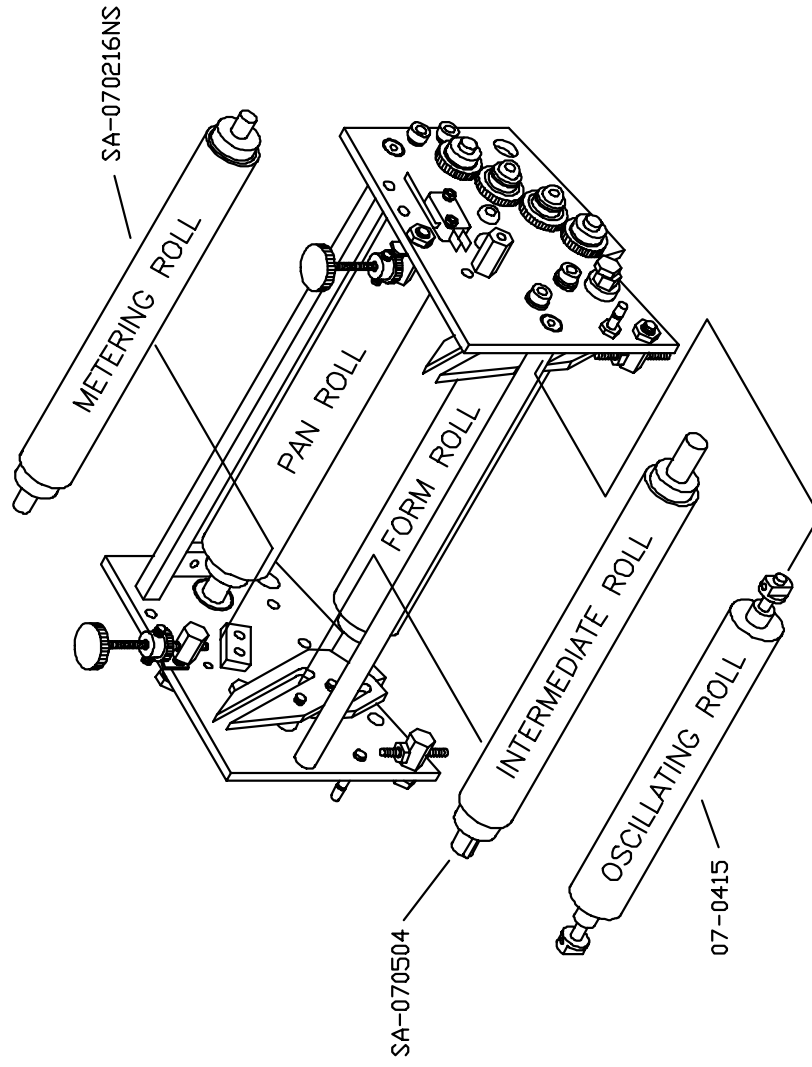

HAMADA 611/611E/612/612E

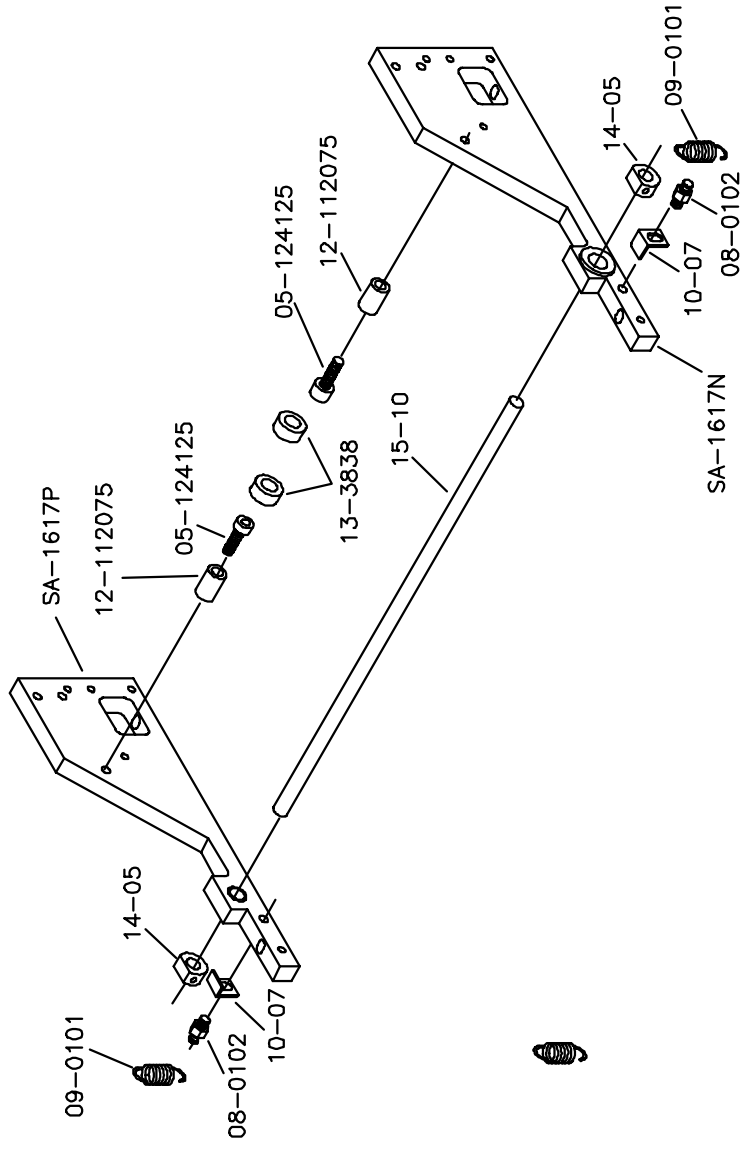

HM611C13 8-19-97

HAMADA 611/611E/612/612E

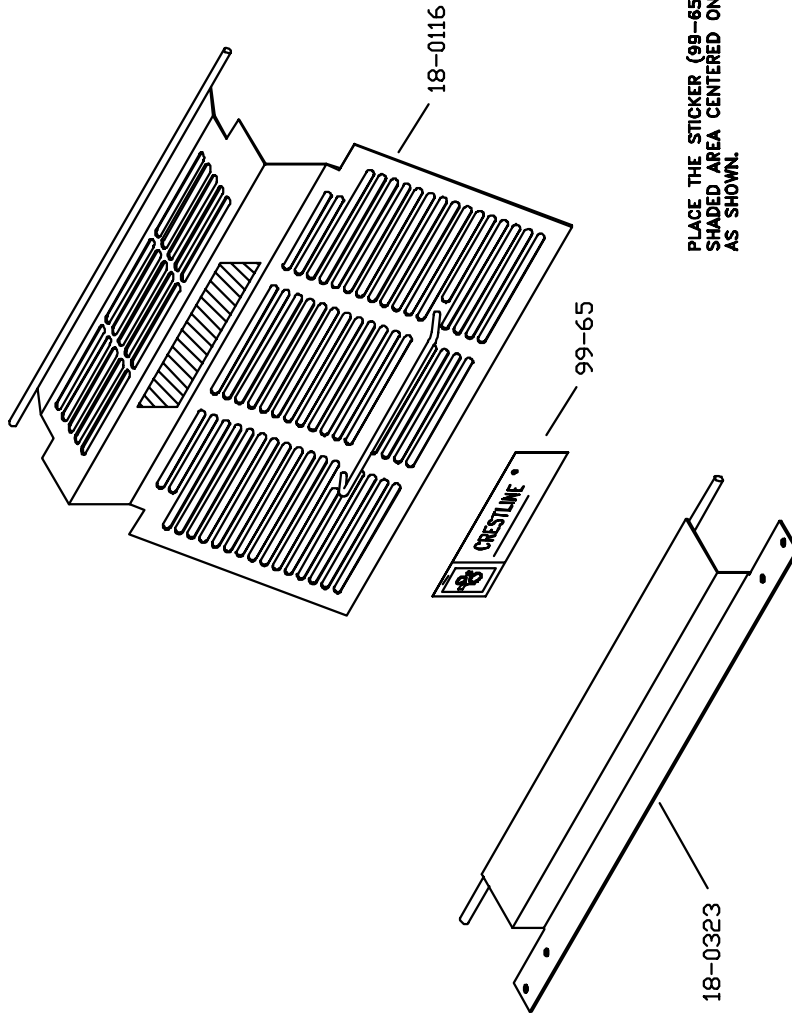

HM611C15 8-20-97

